



MASONRY GARDEN WALL

WALL AT EDGE OF FOOTING

Approved:
1/29/25

Pg 1 of 2

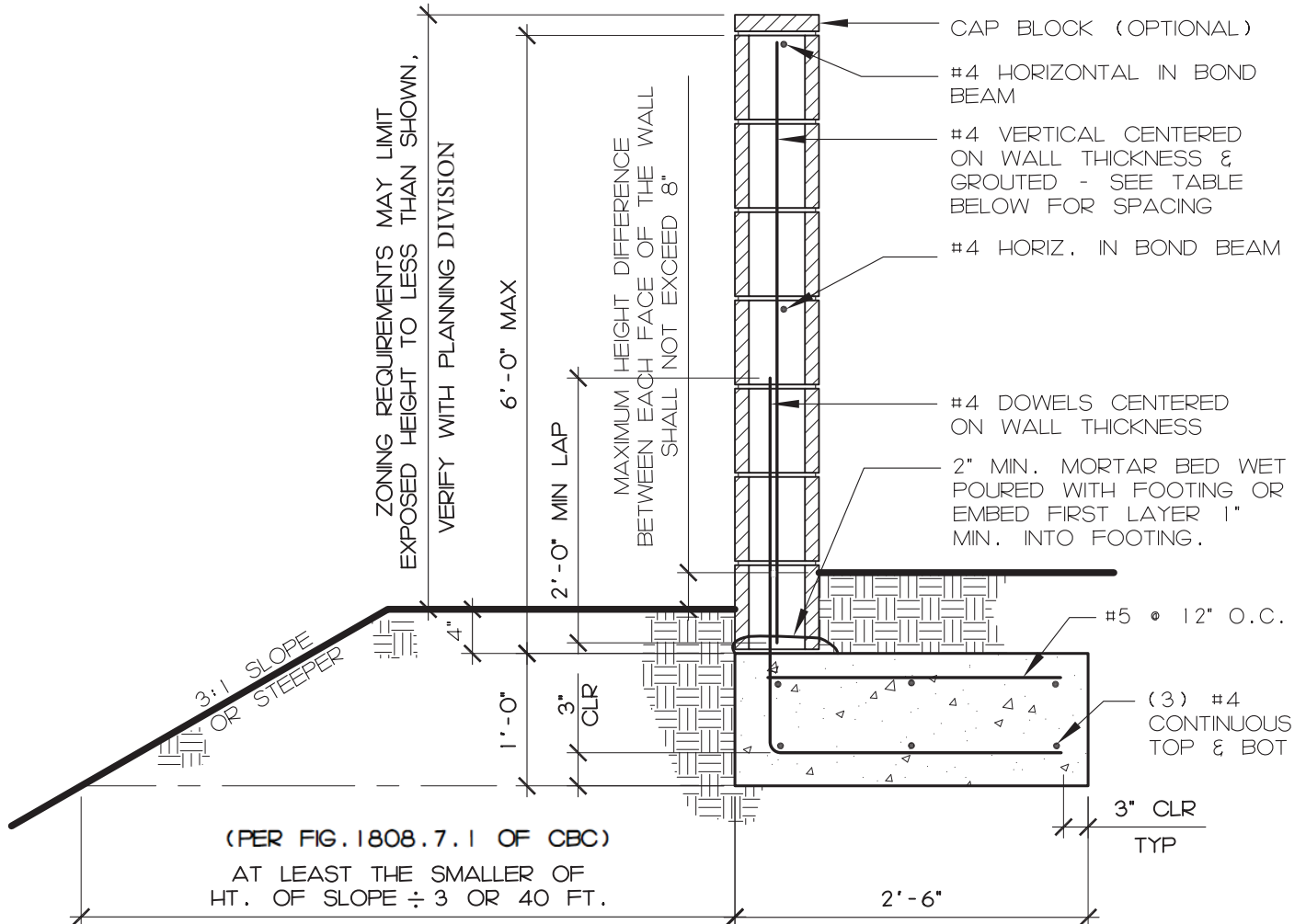

DISCLAIMER:

ALTERNATE WALL DESIGN AND DEVIATION FROM THIS PLAN MAY BE POSSIBLE, WHEN ENGINEERING CALCULATIONS ARE PROVIDED BY A CALIFORNIA LICENSED ENGINEER AND APPROVED BY THE CITY OF EL MONTE

USE OF THIS STANDARD DESIGN PLAN IS AT THE USER'S RISK AND CARRIES NO IMPLIED OR INFERRED GUARANTEE AGAINST FAILURES OR DEFECTS.

ALL SLUMP STONE WALLS SHALL BE A MINIMUM OF 8 INCHES THICK. **NO 6-INCH-THICK SLUMP STONE WALLS ALLOWED.**

SEE OPPOSITE SIDE OF THIS SHEET FOR INSPECTION AND CONSTRUCTION REQUIREMENTS, MATERIAL SPECIFICATIONS, AND DESIGN CRITERIA.

SCHEDULE FOR CMU WALL:

THICKNESS	PARTILLY GROUTED	SOLID GROUTED
6"	24" O.C.	16" O.C.
8"	32" O.C.	24" O.C.



MASONRY GARDEN WALL

WALL AT EDGE OF FOOTING

Approved:
1/29/25

Pg 2 of 2

CONSTRUCTION REQUIREMENTS:

1. All work shall conform to the current California Building Code (CBC) and City adopted ordinances.
2. Minimum reinforcing steel lap splice for # 4 rebar shall be 24" and # 5 shall be 25".
3. Expansion joints are required every 25 feet maximum. No minimum requirement.
4. All cells containing reinforcing steel shall be solid grouted.
5. A minimum of 3-inches of concrete cover is required for all reinforcing steel in footings, with a minimum of 3-inch clearance to soil.
6. **All footings shall be placed on the permittee's (owner's) own property and shall not encroach onto any adjacent parcel unless documentation is provided to authorize such construction. This shall include public trails, parks, flood control channels, El Monte Water District Easements, all other dedicated easements, and similar areas, unless prior approval is obtained by the Public Works Department.**
7. Drainage discharge to adjoining property(s), public trails, flood control channels, dedicated easements, and similar areas, **is not permitted** unless prior approval is obtained by Public Works Department.
8. **Owner shall be responsible to obtain a survey for "all" property lines in question, or as required by this department, the Building Inspector or in a neighbor property line dispute.**

REQUIRED INSPECTIONS:

1. **Foundation:** Footings shall be excavated, free of soil and all debris, and all rebar in place with 3" dobies and wire tied.
2. **Pre-Grout:** All vertical and horizontal reinforcing shall be placed per detail and secured prior to the inspection with rebar grout stops as necessary. The cells containing steel shall be open and unobstructed and all steel shall be placed in the middle of each cell to be grouted.
 - **Partially Grouted Garden Wall Less Than 4'-0" in Height:**
One (1) pre-grout inspection is required for top bond beam.
 - **Partially Grouted Garden Walls Over 4'-0" in Height:**
Mid-height pre-grout inspection for mid-height bond beam and pre-grout inspection for top bond beam will be required.
 - **Solid Grouted Garden Wall:** One (1) pre-grout inspection is required for each grout lift not exceeding 5'-0" in height. Grout lift exceeding 5'-0" in height will require cleanout holes and designed by a California Licensed Engineer subject to City review and approval prior to grouting.
3. Final Inspection: Wall construction completed and grouted. Final grade of soil installed and compacted adjacent to the fence.
4. No Deputy Inspector will be permitted to conduct this inspection, unless authorized by the City prior to the pour.

MATERIAL SPECIFICATIONS:

- Concrete masonry shall conform to ASTM C90, F'm = 1,500 psi.
- Mortar shall be type M, 2500 psi, or Type S, 1800 psi.
- Grout shall conform to ASTM C476, 2,000 psi.
- Concrete shall have a minimum of 4,000 psi, and Type V cement.
- Steel Reinforcing shall be Grade 60, ASTM A615.

DESIGN CRITERIA:

- Compliant with the current California Building Code
- No Seismic Load for Wall Less Than 6' in height.
- Soil Bearing Pressure: 1,500 psi.
- Active Soil Pressure: 60 psf/ft.
- Passive Soil Pressure: 100 psf/ft.
- Soil Density: 115 psf
- Soil Friction: 0.25
- Wind Load: 16.4 psf.